

Universal insulating plate module 3

for district heating multi-line building entry system basic variant 1 and 2

MSH FW Basic M3

Article no.: 1933005200, GTIN: 4052487126632



- **Predetermined breaking point ensures compatibility for use with various diameters**

For insertion in existing perimeter insulation, combined with MSH-FW outer sealing element module 1, module 5 or module 6.

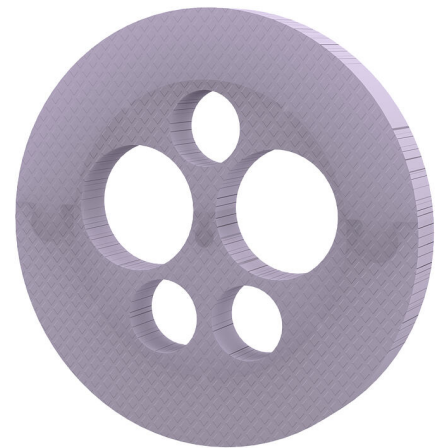

Picture may differ from selected product

FACTS

Advantages:

- Restoration of heat insulation
- Mechanical protection of the building seal

Dimensions:

- OD: 440/299 mm
- Insulation thickness: 50 mm

Material:

- Styrodur (EPS)